



33 Woodvale Road , Farnborough, GU14 6FL

A well presented 2 bedroom 2 bathroom mid terrace house with a private garden and parking located close to good transport links and local amenities. No onward chain.

Price Guide £320,000

33 Woodvale Road

, Farnborough, GU14 6FL



- Entrance hall
- Kitchen
- Bathroom
- Cloakroom
- 2 bedrooms
- Enclosed rear garden
- Sitting/dining room with patio doors to rear garden
- En suite shower room to bedroom 1
- Numbered parking space



Directions
SAT NAV: GU14 6FL



Floor Plan

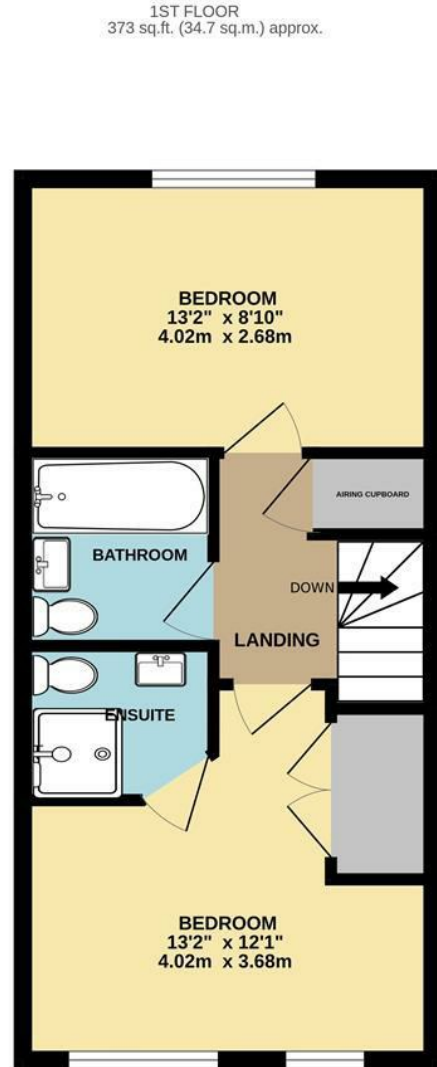
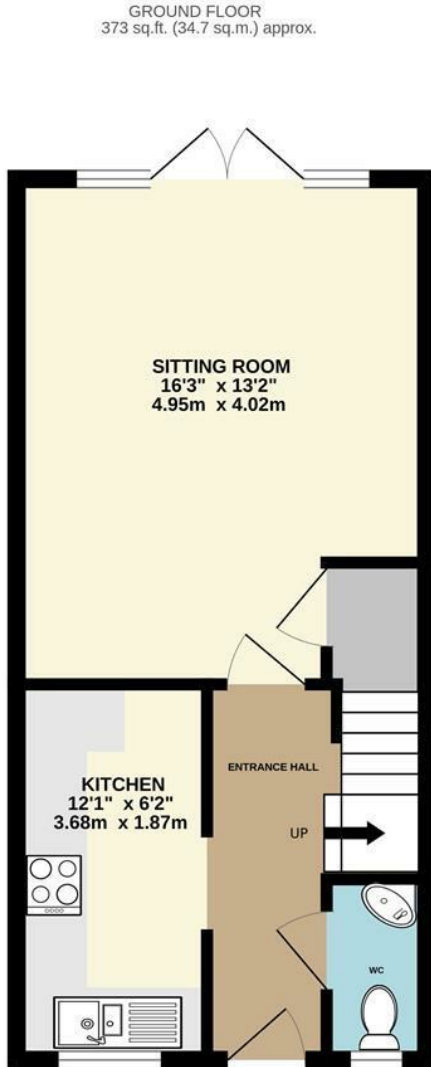

TOTAL FLOOR AREA: 746 sq.ft. (69.3 sq.m.) approx.

Whilst every attempt has been made to ensure the accuracy of the floorplan contained here, measurements of doors, windows, rooms and any other items are approximate and no responsibility is taken for any error, omission or mis-statement. This plan is for illustrative purposes only and should be used as such by any prospective purchaser. The services, systems and appliances shown have not been tested and no guarantee as to their operability or efficiency can be given.
Made with Metropix ©2026



These particulars, whilst believed to be accurate are set out as a general outline only for guidance and do not constitute any part of an offer or contract. Intending purchasers should not rely on them as statements of representation of fact, but must satisfy themselves by inspection or otherwise as to their accuracy. No person in this firm's employment has the authority to make or give any representation or warranty in respect of the property.

